

TO LET

Unit 12
Newgate Shopping Centre
Bishop Auckland



Location

The Newgate Shopping Centre forms part of the prime retail pitch within the town centre.

The subject unit occupies a prominent position with prime frontage on to the internal mall.

Retailers in the immediate vicinity include Wilkinson, New Look, Greggs and EE amongst others.

Accommodation

The unit can be sub-divided to meet specific retailer requirements, with units starting from 2,150 sqft, as shown on the below plan.

The premises comprise the following approximate total net internal floor area:

Demise	Sq. Feet	Sq. Metres
Ground Floor	9,100	845.4

Rent

On application

Tenure

The unit is offered by way of new leases for a term of years to be agreed.

Business Rates

The unit has a 2018 rateable value assessment of £97,000.

The unit would be re-assessed

For further details visit Gov.uk or contact the business rates department in the local authority.

Service Charge

The on-account service charge for the year 2018 stands at approximately £29,774.

EPC

Energy Performance Asset Rating - C

Legal Costs

Each party to be responsible for their own legal and professional costs incurred in this transaction.

VAT

Unless otherwise stated, all prices/rents are quoted exclusive of VAT.

SUBJECT TO CONTRACT

Details prepared January 2018

Viewing Strictly through the joint letting agents.

Barker Proudlove

Mark Proudlove

+44 (0)113 388 4859

+44 (0)7808 479310

mark@barkerproudlove.co.uk

Chris Nutter

+44 (0) 161 631 2852

+44 (0) 7927 561 994

chris@barkerproudlove.co.uk

Rawstron
Johnson

David Rawstron

0113 450 7009

David@rj-ltd.co.uk

Anthony Jackson

0113 450 7009

07711 944 404

Anthony@rj-ltd.co.uk

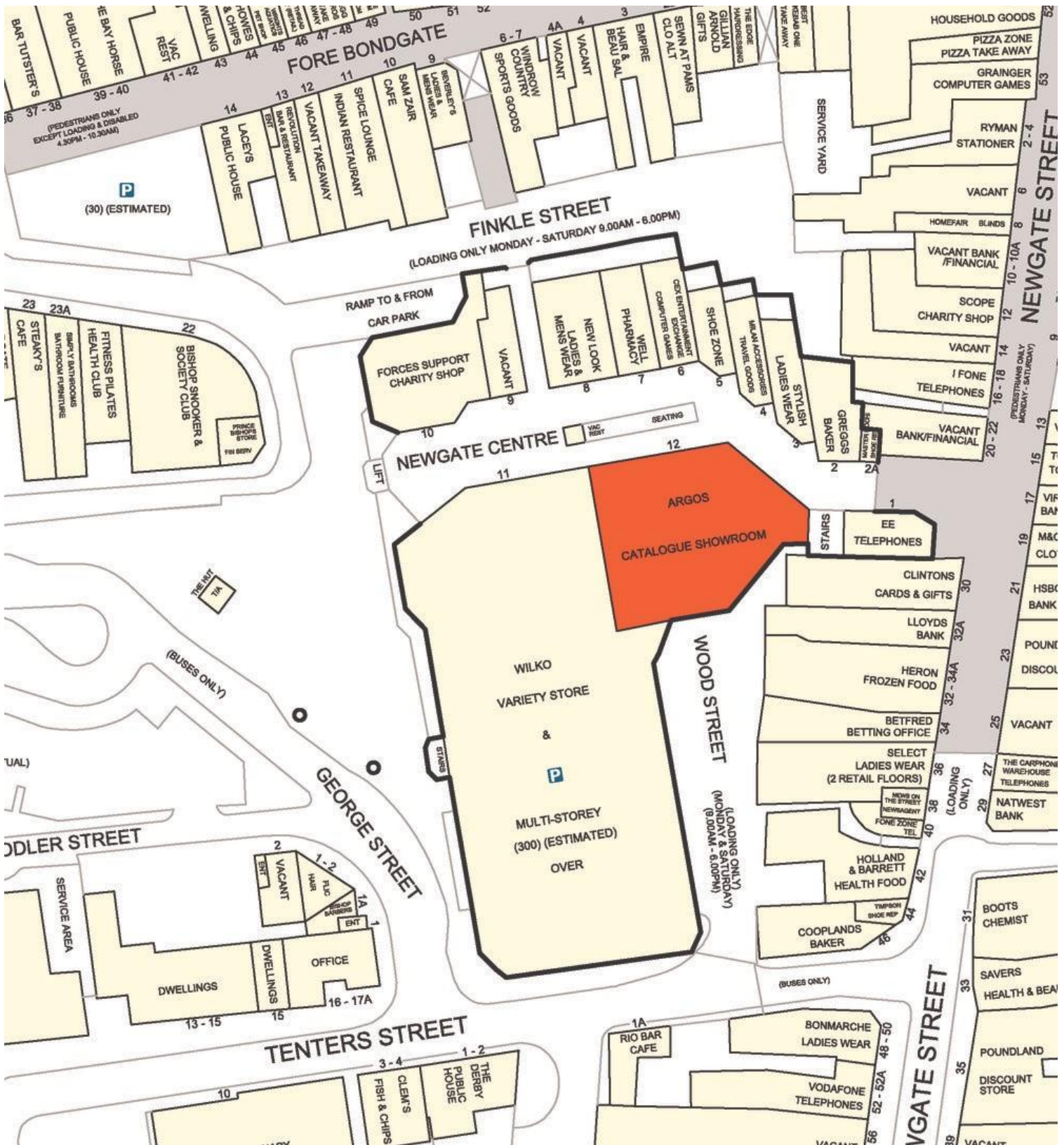

IMPORTANT NOTICE: Barker Proudlove gives notice to anyone who may read these particulars as follows : 1. These particulars are prepared for guidance only of prospective purchasers. They are intended to give a fair overall description of the property, but are not intended to constitute part of an offer or contract. 2. Any information contained herein (whether in the text, plans or photography) is given in good faith but should not be relied upon as being a statement or representation of fact. 3. Nothing in these particulars shall be deemed to be a statement that the property is in good condition or otherwise nor that any services or facilities are in good working order. 4. The photographs appearing in this brochure show only certain aspects of the property at the time when the photographs were taken. Certain aspects may have changed since the photographs were taken and it should not be assumed that the property remains precisely as displayed in the photographs. Furthermore no assumptions should be made in respect of parts of the property which are not shown in the photographs. 5. Any areas, measurements or distances referred to herein are approximate only. 6. Where there is reference in these particulars to the fact alterations have been carried out or that a particular use is made of any part of the property this is not intended to be a statement that any necessary planning, building regulations or other consents have been obtained and these matters must be verified by any intending purchaser. 7. Descriptions of a property are inevitably subjective and the descriptions contained herein are used in good faith as an opinion and not by way of statement of fact. January 2018.

NOTES
Do not scale from this drawing. Only Special Dimensions are to be taken from this drawing. All dimensions are to be taken from the finished floor level unless otherwise stated. All dimensions are to be taken from the finished floor level unless otherwise stated. All dimensions are to be taken from the finished floor level unless otherwise stated. All dimensions are to be taken from the finished floor level unless otherwise stated.

DRAWING STATUSTYPE KEY
 F Finished
 P Planning
 T Tender
 L Location
 S Site
 C Considered
 B Survey
 AD As Built
 OS Ordnance Survey

NOTE: THIS DRAWING IS SUBJECT TO A FULL MEASURED & STRUCTURAL SURVEY. NW ARCHITECTS ACCEPTS NO RESPONSIBILITY FOR THE ACCURACY OF THE ORIGINAL SURVEY.

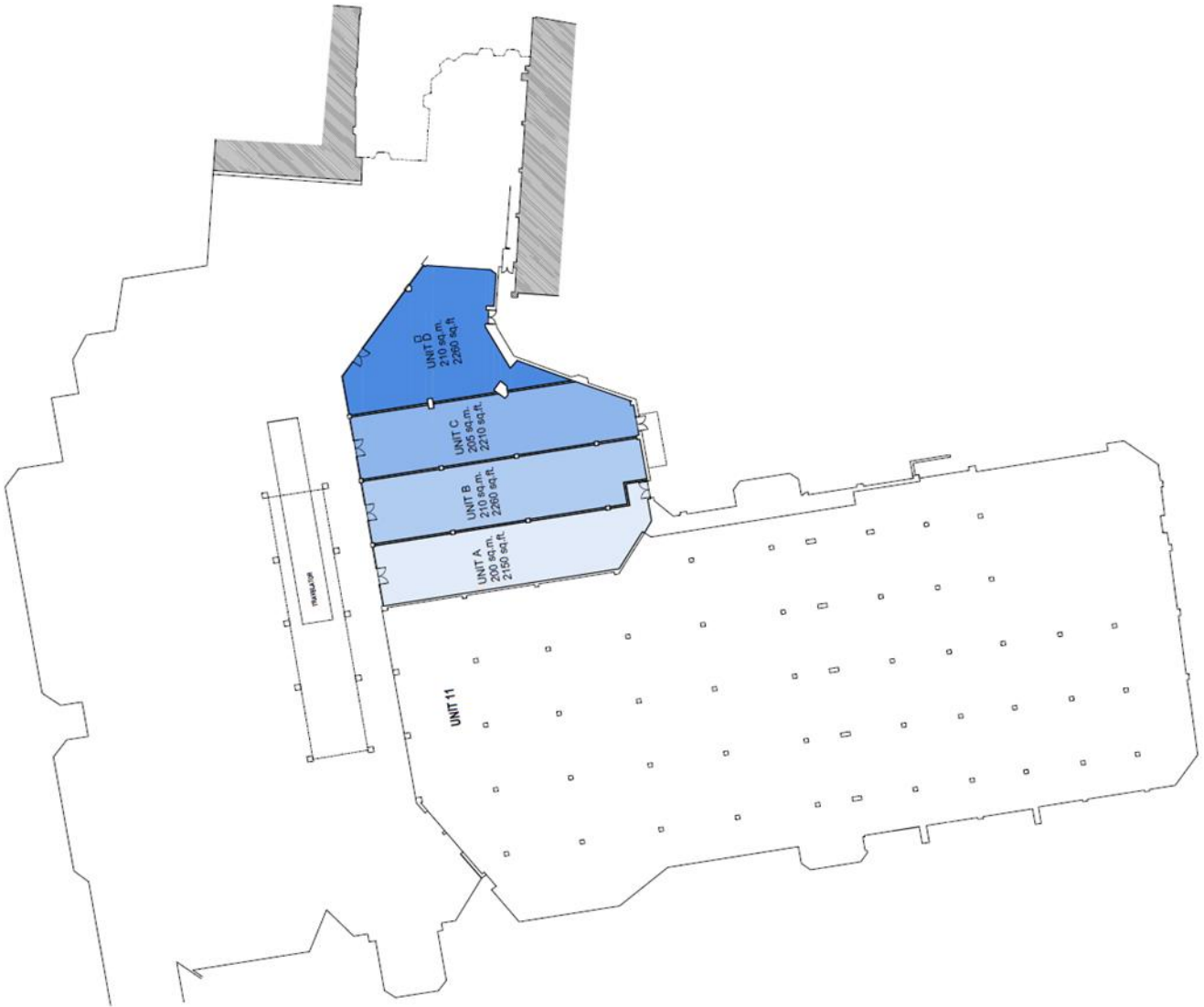

REV	Description	Issued	Date	Project	Unit



17049, Floor 12, 0113 388 4848
 www.nw-architects.co.uk



PROJECT
 Newgate Centre
 Newcastle

UNIT
 Unit 12 Split
 Ground Floor Plan

Scale	1:500 @ A3
Drawn By	MM
Checked By	FP
Issue No.	17049-F100