

TO LET

A3 Planning Potential
Unit 3, Chill Factore
Manchester



Location

Located less than 4 miles away from Manchester City Centre, adjacent to The Trafford Centre. The Chill Factore is a 250,000 sq ft dedicated retail and leisure destination. The Chill Factore can easily be seen from the M60 motorway which has over 53 million passing vehicles per year.

The scheme hosts the UK's longest indoor skiing and snowboarding slope, alongside the strong retail and leisure line up including Snow & Rock, Evans Cycles, Wetherspoons, Nando's and Costa.

The subject unit is located adjacent to Wetherspoons and opposite Costa.

Accommodation

The premises comprise the following approximate net internal floor areas:

Demise	Sq. Feet	Sq. Metres
Ground Floor Sales	1,937	180.0

Rent

Upon application

Tenure

The property is available by the way of a new full repairing and insuring lease of a term to be agreed.

Business Rates

The unit has a 2017 rateable value assessment of £43,500.

For further details visit Gov.uk or contact the business rates department in the local authority.

EPC

Energy Performance Asset Rating - E

Legal Costs

Each party to be responsible for their own legal and professional costs incurred in this transaction.

VAT

Unless otherwise stated, all prices/rents are quoted exclusive of VAT.

SUBJECT TO CONTRACT

Details prepared February 2018

Viewing Strictly through the sole letting agent.

Barker Proudlove

Gary Crompton

+44 (0)161 631 2855

+44 (0)7554 402314

gary@barkerproudlove.co.uk

Phil Coombes

+44(0)113 388 4861

+44(0)7715 678 426

phil@barkerproudlove.co.uk

(450) (ESTIMATED)

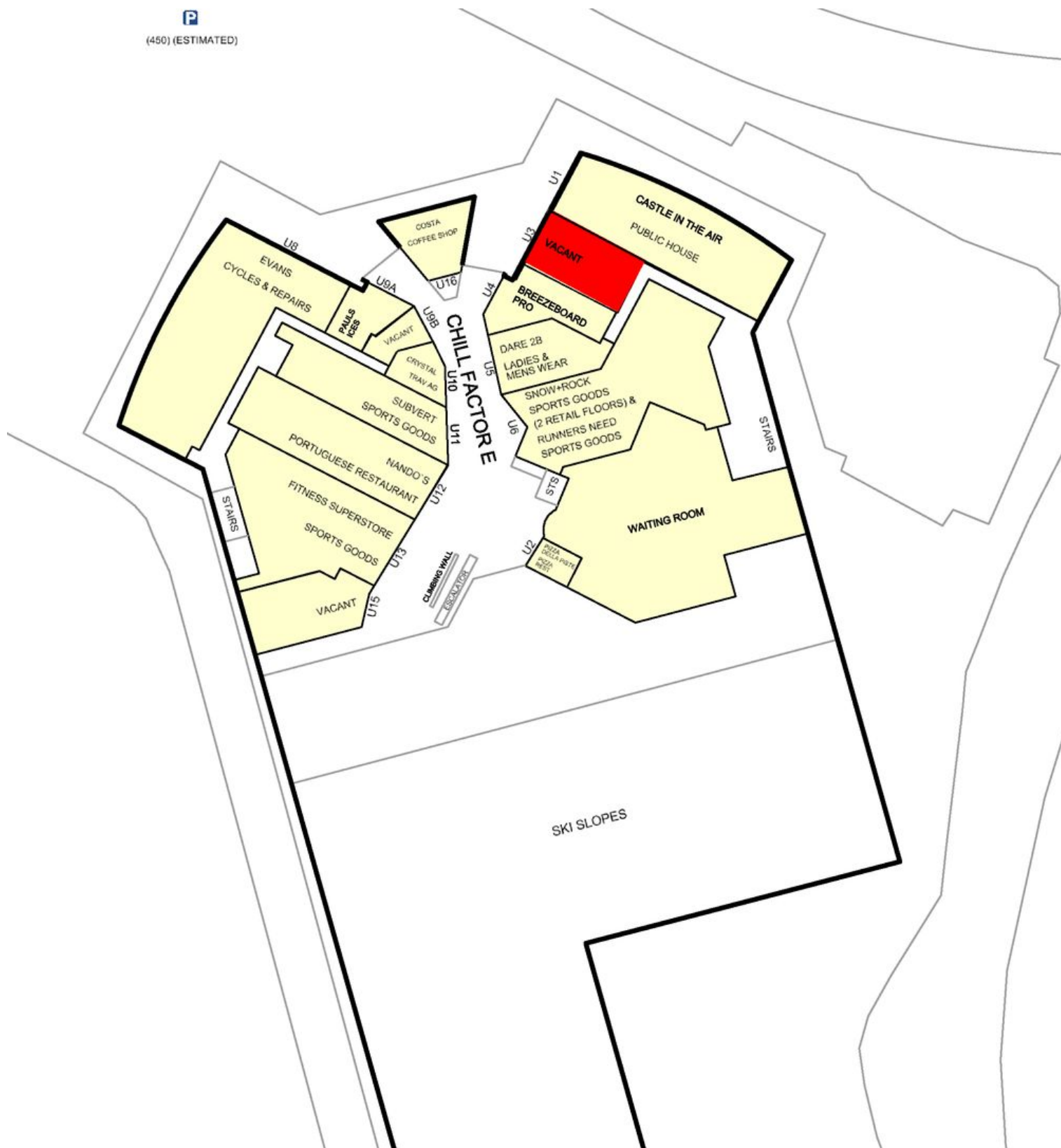

IMPORTANT NOTICE: Barker Proudlove gives notice to anyone who may read these particulars as follows : 1. These particulars are prepared for guidance only of prospective purchasers. They are intended to give a fair overall description of the property, but are not intended to constitute part of an offer or contract. 2. Any information contained herein (whether in the text, plans or photography) is given in good faith but should not be relied upon as being a statement or representation of fact. 3. Nothing in these particulars shall be deemed to be a statement that the property is in good condition or otherwise nor that any services or facilities are in good working order. 4. The photographs appearing in this brochure show only certain aspects of the property at the time when the photographs were taken. Certain aspects may have changed since the photographs were taken and it should not be assumed that the property remains precisely as displayed in the photographs. Furthermore no assumptions should be made in respect of parts of the property which are not shown in the photographs. 5. Any areas, measurements or distances referred to herein are approximate only. 6. Where there is reference in these particulars to the fact alterations have been carried out or that a particular use is made of any part of the property this is not intended to be a statement that any necessary planning, building regulations or other consents have been obtained and these matters must be verified by any intending purchaser. 7. Descriptions of a property are inevitably subjective and the descriptions contained herein are used in good faith as an opinion and not by way of statement of fact. February 2018.