

# To Let

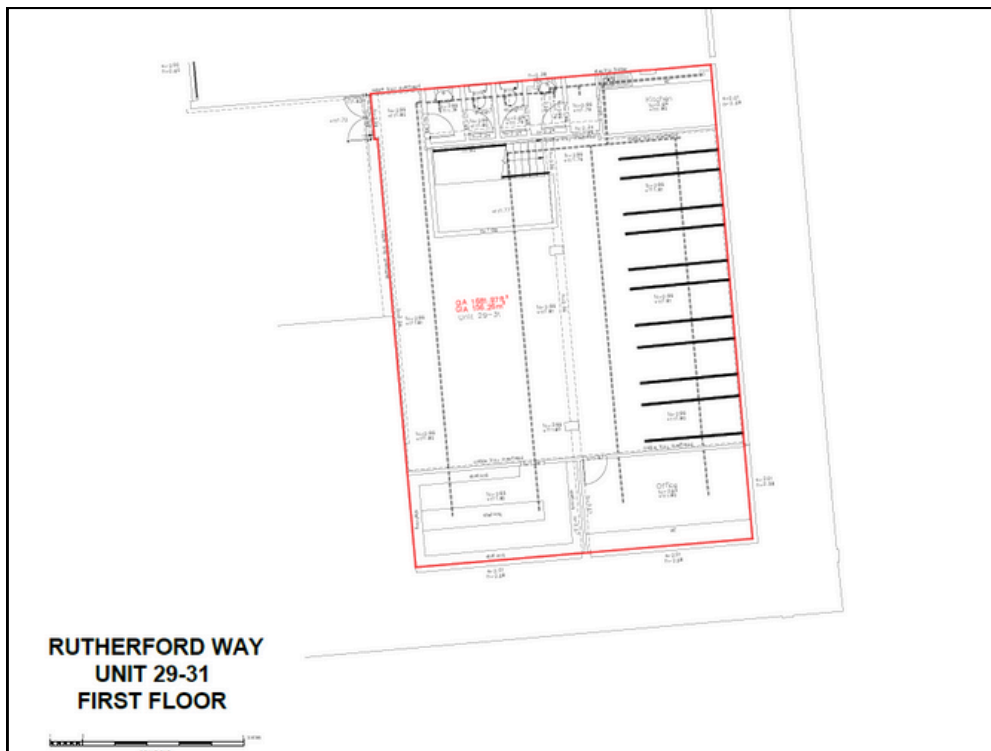

## Hyde

First Floor, 29-31 Rutherford Way,  
Clarendon Square Shopping Centre

1,456 sq ft (135 sq m)

Rent on Application

---

**Location & Description:**

- **Space available for office/storage use.**
- **The subject premises are situated above the recently opened Coffee House store within Clarendon Square.**
- **The unit benefits from its own private access via the service yard.**
- **The location presents a great opportunity from someone requiring town centre office/storage space.**
- **Retailers inside the shopping centre include Coffee House, Superdrug, OneBelow, Bodycare.**

---

**Demise:**

Sales Area 1,456 sq ft (135 sq m)

**Rent:**

Available upon request.

**Lease:**

A new effectively full repairing and insuring lease for a term of years to be agreed.

**Service Charge:**

Available upon request.

**EPC:**

Available upon request.

**Legal and Professional Fees:**

Each party to bear their own costs.

**Rating Assessment:**

To be reassessed following recent re-configuration.

**Date Prepared:**

November 2024

**Contact Us:**

**Jack Deakin**

07591 835782

jack@barkerproudlove.co.uk

**James Lamming**

07715 678630

james@barkerproudlove.co.uk



Hyde



**FIRST FLOOR,  
29-31 RUTHERFORD WAY**

50 metres

Experian Goad Plan Created: 20/11/2024  
Created By: Barker Proudlove Ltd



Copyright and confidentiality Experian, 2024. © Crown copyright and database rights 2024. OS AC0000807366

For more information on our products and services:  
[www.experian.co.uk/business-products/goad](http://www.experian.co.uk/business-products/goad) | [salesG@uk.experian.com](mailto:salesG@uk.experian.com)

**IMPORTANT NOTICE:** Barker Proudlove gives notice to anyone who may read these particulars as follows: 1. These particulars are prepared for guidance only of prospective purchasers. They are intended to give a fair overall description of the property, but are not intended to constitute part of an offer or contract. 2. Any information contained herein (whether in the text, plans or photography) is given in good faith but should not be relied upon as being a statement or representation of fact. 3. Nothing in these particulars shall be deemed to be a statement that the property is in good condition or otherwise nor that any services or facilities are in good working order. 4. The photographs appearing in this brochure show only certain aspects of the property at the time when the photographs were taken. Certain aspects may have changed since the photographs were taken and it should not be assumed that the property remains precisely as displayed in the photographs. Furthermore no assumptions should be made in respect of parts of the property which are not shown in the photographs. 5. Any areas, measurements or distances referred to herein are approximate only. 6. Where there is reference in these particulars to the fact alterations have been carried out or that a particular use is made of any part of the property this is not intended to be a statement that any necessary planning, building regulations or other consents have been obtained and these matters must be verified by any intending purchaser. 7. Descriptions of a property are inevitably subjective and the descriptions contained herein are used in good faith as an opinion and not by way of statement of fact.