

To Let



Hexham

Unit 1 (Homebase), Tyne Valley Retail Park, NE46 1EZ
Retail Park / Class E

Ground Floor: 20,000 sq ft (1,858 sq m)

Rent on Application

Subject to formal vacant possession.

The premises are occupied by Homebase, in Administration.

Location & Description:

- Hexham is a market town in Northumberland, located close to the A69 which links Newcastle c.22 miles to the east, and Carlisle c.38 miles to the west.
- Tyne Valley Retail Park is home to Pets at Home, Poundstretcher and Majestic Wine, providing c.150 car parking spaces.
- Located nearby is Hexham's Wentworth Leisure Centre, Tesco Extra, Waitrose and Next.

Accommodation:

Homebase are the current occupier trading under a recent administration.

The accommodation is arranged over ground and mezzanine floors, with an external garden centre and rear servicing.

Demise:

Ground Floor GIA	20,000 sq ft (1,858 sq m)
Mezzanine GIA	7,000 sq ft (650 sq m)
Garden Centre	6,500 sq ft (604 sq m)

Rent:

Rental offers are invited.

Lease:

Subject to formal vacant possession, the premises are available on a new lease for a term of years to be agreed.

EPC:

Available upon request.

Rating Assessment:

The premises currently has a rateable value of £223,000. For further details visit Gov.uk or contact the business rates department at the local authority.

Service Charge:

The on-account service charge for the year 2024 stands at approximately £17,165.

Legal Costs:

Each party to be responsible for their own legal and professional costs incurred in this transaction.

VAT:

Unless otherwise stated, all prices/rents are quoted exclusive of VAT.

Date Prepared:

November 2024

SUBJECT TO CONTRACT

WITHOUT PREJUDICE

Contact Us: Mark Proudlove
07808 479310

mark@barkerproudlove.co.uk

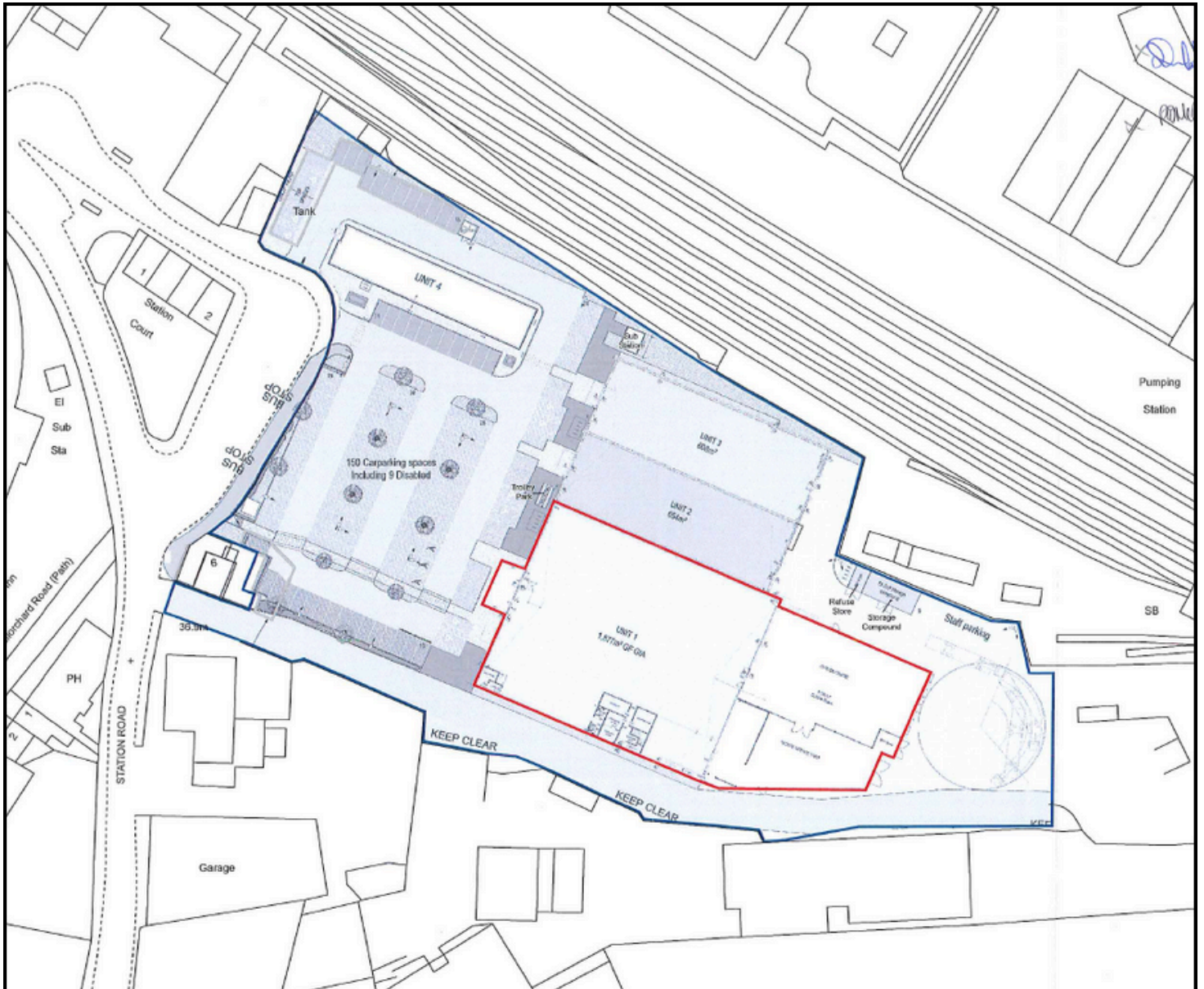

IMPORTANT NOTICE: Barker Proudlove gives notice to anyone who may read these particulars as follows: 1. These particulars are prepared for guidance only of prospective purchasers. They are intended to give a fair overall description of the property, but are not intended to constitute part of an offer or contract. 2. Any information contained herein (whether in the text, plans or photography) is given in good faith but should not be relied upon as being a statement or representation of fact. 3. Nothing in these particulars shall be deemed to be a statement that the property is in good condition or otherwise nor that any services or facilities are in good working order. 4. The photographs appearing in this brochure show only certain aspects of the property at the time when the photographs were taken. Certain aspects may have changed since the photographs were taken and it should not be assumed that the property remains precisely as displayed in the photographs. Furthermore no assumptions should be made in respect of parts of the property which are not shown in the photographs. 5. Any areas, measurements or distances referred to herein are approximate only. 6. Where there is reference in these particulars to the fact alterations have been carried out or that a particular use is made of any part of the property this is not intended to be a statement that any necessary planning, building regulations or other consents have been obtained and these matters must be verified by any intending purchaser. 7. Descriptions of a property are inevitably subjective and the descriptions contained herein are used in good faith as an opinion and not by way of statement of fact.